







ART. 01		Diritto filetto cilindrico maschio con O-Ring Straight male adaptor (parallel)								
CODICE	ØD	G	ØC	ØB	H	L				
0104M5	4	M5	2,6	9	5	20,5	9	2,5	100	
0104M6	4	M6	2,6	9	5	20,5	9	2,5	50	
010418	4	G <sub>1/8</sub>	2,6	13,5	6	20	9	2,5	50	
010414	4	G <sub>1/4</sub>	2,6	17	8	21	9	2,5	50	
0106M5	6	M5	2,6	11	4	22,8	11	2,5	50	
0106M6	6	M6	2,6	11	5	24,8	11	2,5	50	
010618	6	G <sub>1/8</sub>	4,2	13,5	6	25,3	11	4	50	
010614	6	G <sub>1/4</sub>	4,2	17	8	24,3	11	4	50	
010818	8	G <sub>1/8</sub>	5,2	12,8	6	27	13	5	50	
010814	8	G <sub>1/4</sub>	6,2	17	8,2	25,5	13	6	50	
010838	8	G <sub>3/8</sub>	6,2	20	9	25,5	13	6	50	
011014	10	G <sub>1/4</sub>	7,3	16	8	30,4	16	7	50	
011038	10	G <sub>3/8</sub>	8,3	21	9	30,9	16	8	50	
011012	10	G <sub>1/2</sub>	14,1	-	10	24,7	24	8	25	
011214	12	G <sub>1/4</sub>	7,3	16	8	33,2	19	7	25	
011238	12	G <sub>3/8</sub>	10,3	22	9	33,2	19	10	25	
011212	12	G <sub>1/2</sub>	10,3	24	11	33,2	19	10	25	
011438	14	G <sub>3/8</sub>	10,3	21	9	35	21	10	25	
011412	14	G <sub>1/2</sub>	10,3	24	11	32,5	21	10	25	

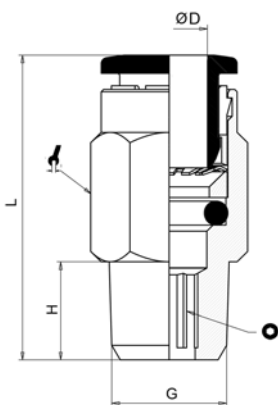

ART. 01C		Diritto filetto conico maschio Straight male adaptor (tapered)								
CODICE	ØD	G		H	L					
01C0418	4	G <sub>1/8</sub>		7,5	18	10	2,5	50		
01C0414	4	G <sub>1/4</sub>		9,5	16	14	2,5	50		
01C0438	4	G <sub>3/8</sub>		7,5	17,4	17	3	25		
01C0618	6	G <sub>1/8</sub>		7,5	19,5	12	4	50		
01C0614	6	G <sub>1/4</sub>		9,5	22,3	14	4	50		
01C0638	6	G <sub>3/8</sub>		10,5	20,3	17	4	25		
01C0612	6	G <sub>1/2</sub>		10	23,2	24	4	25		
01C0818	8	G <sub>1/8</sub>		7,5	25,5	14	5	50		
01C0814	8	G <sub>1/4</sub>		9,5	24,5	14	6	50		
01C0838	8	G <sub>3/8</sub>		10,5	21,5	17	6	50		
01C0812	8	G <sub>1/2</sub>		12,5	25,5	21	6	25		
01C1018	10	G <sub>1/8</sub>		7,5	29,5	17	4	25		
01C1014	10	G <sub>1/4</sub>		9,5	30,8	17	7	50		
01C1038	10	G <sub>3/8</sub>		10,5	28,3	17	8	50		
01C1012	10	G <sub>1/2</sub>		13,5	26,6	21	8	25		
01C1218	12	G <sub>1/8</sub>		7	31	21	4	25		
01C1214	12	G <sub>1/4</sub>		9,5	33	21	7	25		
01C1238	12	G <sub>3/8</sub>		10,5	30	21	10	25		
01C1212	12	G <sub>1/2</sub>		13,5	32,5	21	10	25		
01C1438	14	G <sub>3/8</sub>		9	37,5	21	10	25		
01C1412	14	G <sub>1/2</sub>		11	35	22	10	25		

**ART. 02** Diritto femmina  
Straight female adaptor

CODICE	ØD	G	ØC	ØB	H	L		
0204M5	4	M5	5	9	4,5	23	9	50
020418	4	G <sub>1/8</sub>	3	12	6,5	26,5	9	50
020414	4	G <sub>1/4</sub>	3	17	10	29,5	9	50
020618	6	G <sub>1/8</sub>	5	12	6,5	28,3	11	50
020614	6	G <sub>1/4</sub>	5	17	10	31,3	11	50
020818	8	G <sub>1/8</sub>	7	12	6,5	28,5	13	50
020814	8	G <sub>1/4</sub>	7	17	10	32,5	13	50

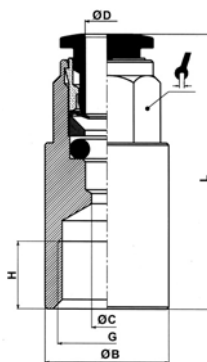

**ART. 03** Diritto innestabile  
Straight connector

CODICE	ØD		ØB	ØC	L		
030400	4		3	11	32		50
030600	6		5	13	36,1		50
030800	8		7	15	38		50
031000	10		9	18	42,3		50
031200	12		11	21	45,8		25
031400	14		13	23	48,9		25

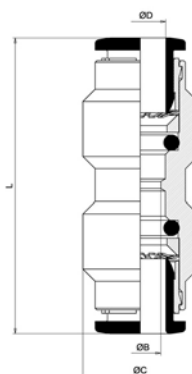

**ART. 03F** Intermedio  
Straight connector

CODICE	ØD		ØC	ØB	L		
03F0400	4		3	M11	32		50
03F0500	5		4	M11	33		50
03F0600	6		5	M14	36,1		50
03F0800	8		7	M16	38		50
03F1000	10		9	M18	42,3		50
03F1200	12		11	M22	45,8		25
03F1400	14		13	M24	47,5		25

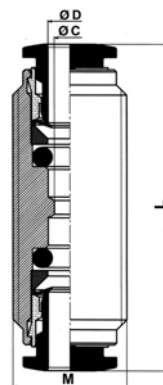

**ART. 04** Gomito innestabile  
Elbow connector

CODICE	ØD		ØC	ØB	L		
040400	4		4	10	19		50
040600	6		5	11	20,6		50
040800	8		7	13	23		50
041000	10		8	16	26,4		50
041200	12		10	19	28,9		25
041400	14		12	21	31,5		25

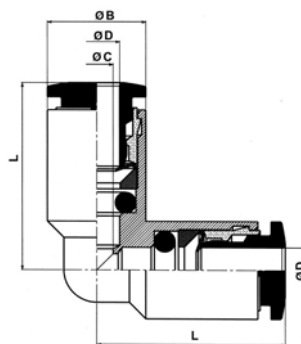

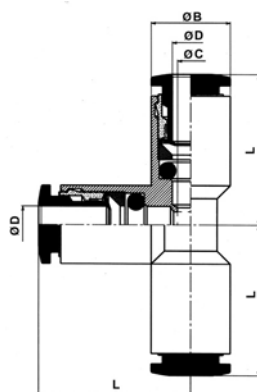

### ART. 05 T innestabile T connector

CODICE	ØD	ØC	ØB	L		
050400	4	3	9	17,3		50
050600	6	5	11	20,6		50
050800	8	7	13	23		50
051000	10	8	16	26,4		25
051200	12	10	19	28,9		25
051400	14	12	21	31,5		25

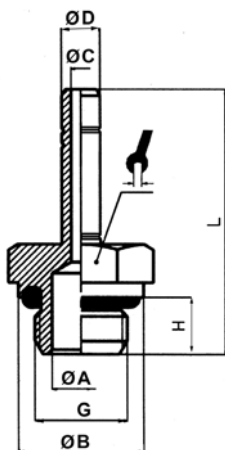

### ART. 06 Innesto, filetto cilindrico con O-Ring Adaptor parallel (short)

CODICE	ØD	G	ØC	ØB	H	L	ØA		
0604M5	4	M5	2	8	4	24,7	2	8	50
0604M6	4	M6	2	9	5	25,7	2	8	50
0604M7	4	M6	2	11	5	26,2	2	9	50
060418	4	G <sub>1/8</sub>	2	13	6	28,2	6	13	50
060414	4	G <sub>1/4</sub>	2	16	8	30,7	7,5	13	50
0606M5	6	M5	2,6	8	4	27,5	2,6	8	50
0606M6	6	M6	2,6	9	5	29	2,6	8	50
0606M7	6	M7	3,5	11	5,5	29	3,5	9	50
060618	6	G <sub>1/8</sub>	4	13	6	31	6	13	50
060614	6	G <sub>1/4</sub>	4	16	8	33,5	7,5	13	50
060818	8	G <sub>1/8</sub>	6	13	6	32,5	6	13	50
060814	8	G <sub>1/4</sub>	6	16	8	33	7,5	13	50
060838	8	G <sub>3/8</sub>	6	20	9	37	9	13	50
061018	10	G <sub>1/8</sub>	6	13	6	35,5	6	13	50
061014	10	G <sub>1/4</sub>	8	16	8	38	8	13	50
061038	10	G <sub>3/8</sub>	8	20	9	41	8	13	50
061214	12	G <sub>1/4</sub>	8	16	8	39	8	13	25
061238	12	G <sub>3/8</sub>	10	20	9	42	11	13	25
061212	12	G <sub>1/2</sub>	10	24	11	44	13	16	25
061438	14	G <sub>3/8</sub>	12	20	9	44,5	12	16	25
061412	14	G <sub>1/2</sub>	12	24	11	46,5	13	16	25

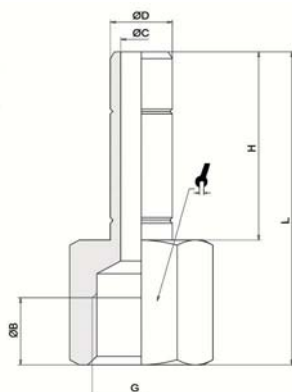

### ART. 06F Innesto filetto cilindrico femmina Female parallel adaptor

CODICE	ØD	G	ØC	ØB	H	L		
06F0418	4	G <sub>1/8</sub>	2	7	16,7	29,7	12	50
06F0618	6	G <sub>1/8</sub>	4	7	19,5	32,5	12	50
06F0614	6	G <sub>1/4</sub>	4	8	19,5	35,5	17	50
06F0814	8	G <sub>1/4</sub>	6	8	21	37	17	50

**ART. 60** Innesto prolungato filetto cilindrico con O-Ring  
Adaptor parallel long

CODICE	ØD	G	ØC	ØB	H	L	ØA		
600418	4	G <sub>1/8</sub>	2	13	6	39,7	6	13	50
600618	6	G <sub>1/8</sub>	4	13	6	45	6	13	50
600614	6	G <sub>1/4</sub>	4	16	8	47,5	7,5	13	50
600818	8	G <sub>1/8</sub>	6	13	6	48,5	6	13	50
600814	8	G <sub>1/4</sub>	6	16	8	51	7,5	13	50
600838	8	G <sub>3/8</sub>	6	20	9	51,5	9	13	50
601014	10	G <sub>1/4</sub>	8	16	8	55,5	7,5	13	50
601038	10	G <sub>3/8</sub>	8	13	9	57,5	9	13	25

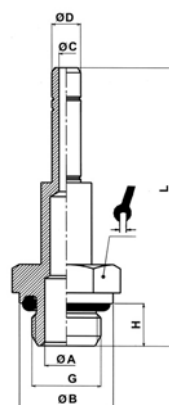

**ART. 07** Prolungamento  
Connector

CODICE	ØD	ØC	L	
070400	4	2	32,5	100
070600	6	4	39	50
070800	8	6	42	50
071000	10	8	48	50
071200	12	10	50	25
071400	14	12	53	25

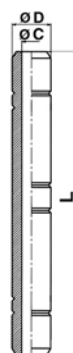

**ART. 08** Riduzione con codolo  
Plug-in reducer

CODICE	ØD1	ØD2	ØB	L	
080604	6	4	9	32,5	50
080804	8	4	9	34	50
080806	8	6	11	36	50
081006	10	6	11	39,3	50
081008	10	8	13	39	50
081204	12	4	13	40	25
081206	12	6	13	40,3	25
081208	12	8	13	39,5	25
081210	12	10	16	41,4	25
081404	14	4	15	43,5	25
081406	14	6	15	43,8	25
081408	14	8	15	44	25
081410	14	10	16	43,9	25
081412	14	12	19	45,9	25

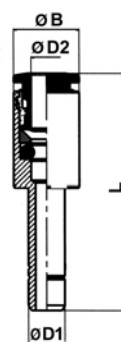

**ART. 08/E** Maggiorazione con codolo  
Plug-in increaser

CODICE	ØD1	ØD2	ØB	L	
08E0406	4	6	11	35,5	50
08E0608	6	8	13	39	50

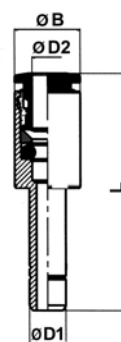

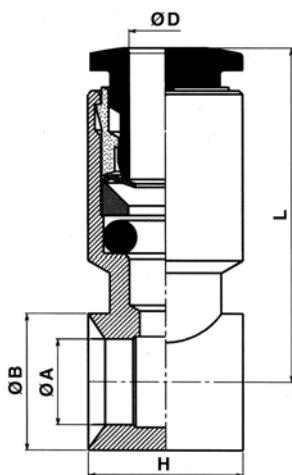
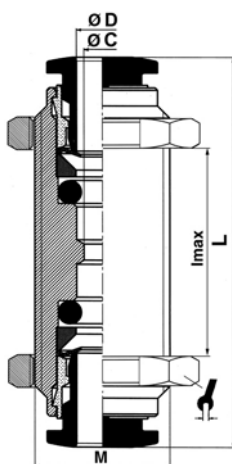
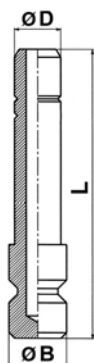

### ART. 09 Tappo Plug

CODICE	ØD	ØB			L	
090400	4	5			26	50
090600	6	7			29	50
090800	8	9			31,5	50
091000	10	11			35	50
091200	12	13			37	25
091400	14	15			39,5	25

### ART. 10 Passaparete Bulkhead connector

CODICE	ØD	ØC	M	Lmax	L		
100400	4	3	11x1	8	32	14	50
100600	6	5	14x1	8	36,1	17	50
100800	8	7	16x1	10	38	18	50
101000	10	9	18x1	12	42,3	21	25
101200	12	11	22x1	17	45,8	20	25
101400	14	13	24x1	18	47,5	27	25

### ART. 13 Anello semplice Single banjo body

CODICE	ØD	G*	ØA	ØB	H	L	
1304M5	4	M5	5	8	9	19,5	50
130418	4	G <sub>1/8</sub>	9,9	14	15	21,1	50
130618	6	G <sub>1/8</sub>	9,9	14	15	24,3	50
130614	6	G <sub>1/4</sub>	13,3	18	17	25,5	50
130638	6	G <sub>3/8</sub>	16,75	21	20	28	25
130818	8	G <sub>1/8</sub>	9,9	14	15	24,8	50
130814	8	G <sub>1/4</sub>	13,3	18	17	26,5	50
130838	8	G <sub>3/8</sub>	16,75	21	20	28,0	50
131014	10	G <sub>1/4</sub>	13,3	18	17	28,4	50
131038	10	G <sub>3/8</sub>	16,75	21	20	29,9	25
131214	12	G <sub>1/4</sub>	13,3	18	17	30,9	25
131238	12	G <sub>3/8</sub>	16,75	21	20	31,4	25
131212	12	G <sub>1/2</sub>	21	26	24	34,9	25
131412	14	G <sub>1/2</sub>	21	26	24	35,5	25

(\*) G = Filetto vite/asta  
G = Steam thread

**ART. 14** Anello doppio  
Double banjo body

CODICE	ØD	G*	ØA	ØB	H	L			
1404M5	4	M5	5	8	9	19,5			50
140418	4	G <sub>1/8</sub>	9,9	14	15	21,1			50
140618	6	G <sub>1/8</sub>	9,9	14	15	24,3			50
140614	6	G <sub>1/4</sub>	13,3	18	17	25,5			50
140818	8	G <sub>1/8</sub>	9,9	14	15	24,8			50
140814	8	G <sub>1/4</sub>	13,3	18	17	26,5			50
140838	8	G <sub>3/8</sub>	16,75	21	20	28			50
141014	10	G <sub>1/4</sub>	13,3	18	17	28,4			50
141038	10	G <sub>3/8</sub>	16,75	21	20	29,9			25

(\*) G = Filetto vite/asta  
G = Steam thread

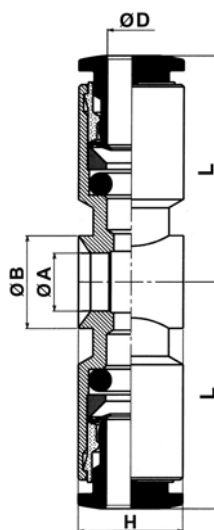

**ART. 15** Anello semplice girevole con asta  
Complete single banjo (rotating under pressure)

CODICE	ØD	G	ØA	H	L <sub>1</sub>	L		⊙	
1504M5	4	M5	2	4	16,8	19,5		2,5	50
1504M6	4	M6	2	4	16,8	19,5		2,5	50
150418	4	G <sub>1/8</sub>	5,5	6	25	21,1		3	50
1506M5	6	M5	2	4	16,5	22		2,5	50
150618	6	G <sub>1/8</sub>	5,5	6	25	24,3		3	50
150614	6	G <sub>1/4</sub>	7,8	8	29,5	25,5		4	50
150638	6	G <sub>3/8</sub>	7,8	9	34	28		5	25
150818	8	G <sub>1/8</sub>	5,5	6	25	24,8		3	50
150814	8	G <sub>1/4</sub>	7,8	8	29,3	26,5		4	50
150838	8	G <sub>3/8</sub>	10	9	34	28		5	25
151014	10	G <sub>1/4</sub>	7,8	8	29,3	28,4		4	25
151038	10	G <sub>3/8</sub>	10	9	34	29,9		5	25
151214	12	G <sub>1/4</sub>	7,8	8	29,3	30,9		4	25
151238	12	G <sub>3/8</sub>	10	9	34	31,4		5	25
151212	12	G <sub>1/2</sub>	12	11	40,8	34,9		8	20
151412	14	G <sub>1/2</sub>	12	11	40,8	35,5		8	20

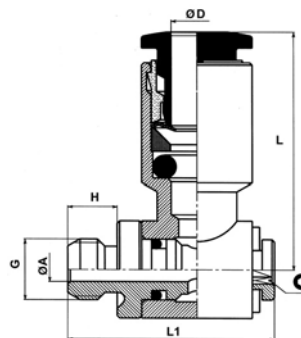

**ART. 16** Anello doppio girevole con asta  
Complete double banjo (rotating under pressure)

CODICE	ØD	G	ØA	H	L <sub>1</sub>	L		⊙	
1604M5	4	M5	2	4	16,8	19,5		2,5	50
160418	4	G <sub>1/8</sub>	5,5	6	25	21,1		3	50
160618	6	G <sub>1/8</sub>	5,5	6	25	24,3		3	50
160614	6	G <sub>1/4</sub>	7,8	8	29,3	25,5		4	50
160818	8	G <sub>1/8</sub>	5,5	6	25	24,8		3	50
160814	8	G <sub>1/4</sub>	7,8	8	29,3	26,5		4	25
160838	8	G <sub>3/8</sub>	10	9	34	28		5	25
161014	10	G <sub>1/4</sub>	7,8	8	29,3	28,4		4	25
161038	10	G <sub>3/8</sub>	10	9	34	29,9		5	25

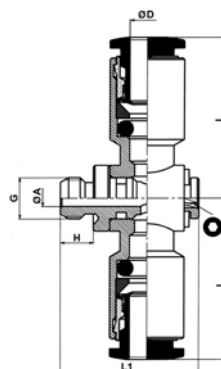



ART. 22

Gomito girevole filetto cilindrico maschio con O-Ring  
Swivel elbow male adaptor parallel

CODICE	ØD	A	H	ØB	L1	L2		
2204M5	4	M5	4	9	17,3	20	8	100
220418	4	G <sub>1/8</sub>	6	11	17,3	18,5	13	100
220414	4	G <sub>1/4</sub>	8	9	19	22,5	16	100
2206M5	6	M5	4	11	20	20,6	8	100
220618	6	G <sub>1/8</sub>	6	11	20,6	18,5	13	100
220614	6	G <sub>1/4</sub>	8	11	22,1	22,5	16	100
220818	8	G <sub>1/8</sub>	6	13	23	20,5	13	100
220814	8	G <sub>1/4</sub>	8	13	23	22,5	16	100
220838	8	G <sub>3/8</sub>	9	13	24,5	25,5	18	50
221014	10	G <sub>1/4</sub>	8	16	26,4	24,5	16	50
221038	10	G <sub>3/8</sub>	9	16	26,4	25,5	18	50
221012	10	G <sub>1/2</sub>	11	17	27,9	29,0	21	50
221214	12	G <sub>1/4</sub>	8	19	28,9	24,5	16	50
221238	12	G <sub>3/8</sub>	9	19	28,9	24,5	18	50
221212	12	G <sub>1/2</sub>	11	19	28,9	31	21	25
221438	14	G <sub>3/8</sub>	9	21	31,5	28	18	25
221412	14	G <sub>1/2</sub>	11	21	31,5	33	21	25

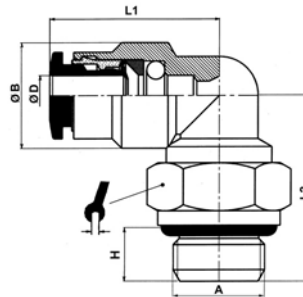

ART. 25

Passaparete femmina  
Female bulkhead

CODICE	ØA	C	ØB	D	E	L		
250418	4	G <sub>1/8</sub>	M10	15,5	6,5	25,5	15	25
250618	6	G <sub>1/8</sub>	M14	15,8	6,5	26,8	15	25
250614	6	G <sub>1/4</sub>	M14	15,8	10	31,3	17	25
250818	8	G <sub>1/8</sub>	M16	16	6,5	29	17	25
250814	8	G <sub>1/4</sub>	M16	16	10	33,5	17	25

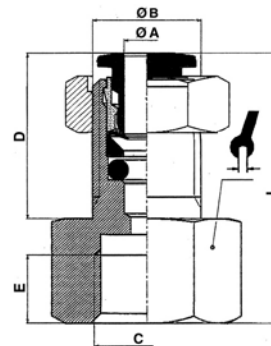

ART. 27

Cartuccia per corpo di plastica  
Cartridge

CODICE	ØD	ØC	ØB	H	
270400	4	2,9	7,8	14	100
270600	6	5	10	16	50
270800	8	7	11,8	17	50

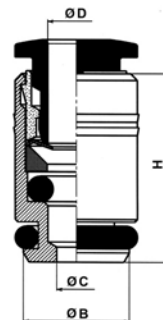

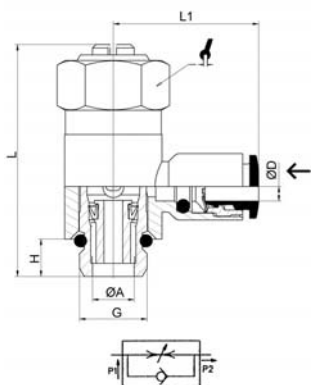

**ART. 28** Regolatore di flusso unidirezionale per valvola  
Unidirectional flow regulator for valve

CODICE	ØD	G	ØA	H	L1	L		
2804M5	4	M5	1,9	4	19,5	21,5	10	25
280418	4	G <sub>1/8</sub>	5,5	5,5	21,1	34	14	25
280618	6	G <sub>1/8</sub>	5,5	5,5	24,3	34	14	25
280614	6	G <sub>1/4</sub>	6	6	25,5	42	17	25
280818	8	G <sub>1/8</sub>	5,5	5,5	24,8	34	14	25
280814	8	G <sub>1/4</sub>	6	6	26,5	42	17	25
280838	8	G <sub>3/8</sub>	8	8	28	52	20	25
281014	10	G <sub>1/4</sub>	6	6	28,4	42	17	25
281038	10	G <sub>3/8</sub>	8	8	29,9	52	20	10
281238	12	G <sub>3/8</sub>	8	8	31,4	52	20	10

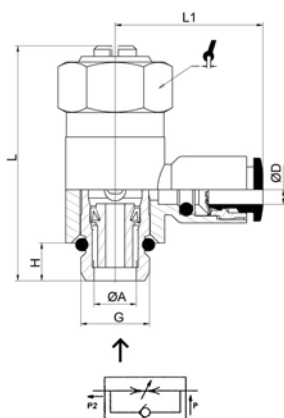

**ART. 29** Regolatore di flusso unidirezionale per cilindro  
Unidirectional flow regulator for cylinder

CODICE	ØD	G	ØA	H	L1	L		
2904M5	4	M5	1,9	4	19,5	21,5	10	25
290418	4	G <sub>1/8</sub>	5	5,5	21,1	34	14	25
2906M5	6	M5	1,9	4	22,5	21,5	10	25
290618	6	G <sub>1/8</sub>	5	5,5	24,3	34	14	25
290614	6	G <sub>1/4</sub>	6	6	25,5	42	17	25
290818	8	G <sub>1/8</sub>	5	5,5	24,8	34	14	25
290814	8	G <sub>1/4</sub>	6	6	26,5	42	17	25
290838	8	G <sub>3/8</sub>	6,5	8	28	52	20	25
291014	10	G <sub>1/4</sub>	6	6	28,4	42	17	25
291038	10	G <sub>3/8</sub>	6,5	8	29,9	52	20	10
291238	12	G <sub>3/8</sub>	6,5	8	31,4	52	20	10
291212	12	G <sub>1/2</sub>	10	10	34,9	61	26	10

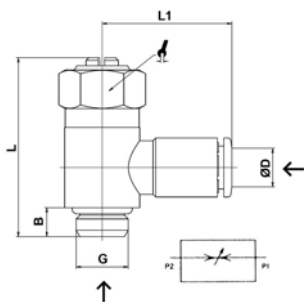



**ART. 30** Regolatore di flusso bidirezionale  
Bidirectional flow regulator

CODICE	ØD	G	B	L1	L		
300418	4	G <sub>1/8</sub>	5,5	21,1	34	14	25
300618	6	G <sub>1/8</sub>	5,5	24,3	34	14	25
300614	6	G <sub>1/4</sub>	6	25,5	42	17	25
300818	8	G <sub>1/8</sub>	5,5	24,8	34	14	25
300814	8	G <sub>1/4</sub>	6	26,5	42	17	25
*300838	8	G <sub>3/8</sub>	8	28	52	20	25
301014	10	G <sub>1/4</sub>	6	28,4	42	17	25
*301038	10	G <sub>3/8</sub>	8	29,9	52	20	10
*301238	12	G <sub>3/8</sub>	8	31,4	52	20	10
*301212	12	G <sub>1/2</sub>	10	34,9	61	26	10



\* con rondelle in plastica  
with plastic washer

## ART. 28P Regolatore di flusso per valvola girevole Swivel flow regulator for valve

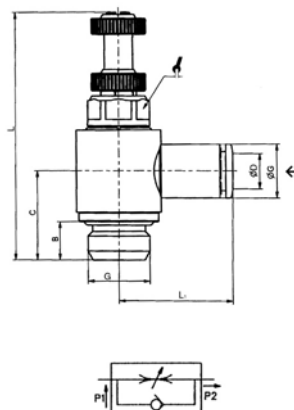
CODICE	ØD	G	B	L	L1		
2804M5P	4	M5	33,7	19,5	4	8	25
280418P	4	G 1/8	5,5	43	21,1	9	25
280618P	6	G 1/8	5,5	43	24,3	9	25
280818P	8	G 1/8	5,5	43	24,8	9	25
280614P	6	G 1/4	6,5	50	25,5	12	25
280814P	8	G 1/4	6,5	50	26,5	12	25
281014P	10	G 1/4	6,5	50	28,4	12	25



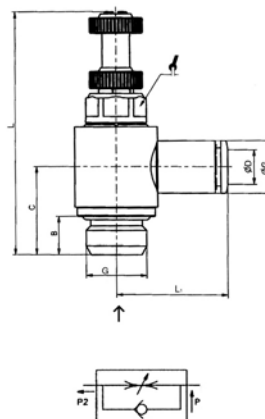

## ART. 29P Regolatore di flusso per cilindro girevole Swivel flow regulator for cylinder

CODICE	ØD	G	B	L	L1		
2904M5P	4	M5	33,7	19,5	4	8	25
290418P	4	G 1/8	5,5	43	21,1	9	25
2906M5P	4	M5	33,7	22	6	8	25
290618P	6	G 1/8	5,5	43	24,3	9	25
290818P	8	G 1/8	5,5	43	24,8	9	25
290614P	6	G 1/4	6,5	50	25,5	12	25
290814P	8	G 1/4	6,5	50	26,5	12	25
291014P	10	G 1/4	6,5	50	28,4	12	25



## ART. 30P Regolatore di flusso bidirezionale Bidirectional flow regulator

CODICE	ØD	G	B	L	L1		
300418P	4	G 1/8	5,5	43	21,1	9	25
300618P	6	G 1/8	5,5	43	24,3	9	25
300818P	8	G 1/8	5,5	43	24,8	9	25
300614P	6	G 1/4	6,5	50	25,5	12	25
300814P	8	G 1/4	6,5	50	26,5	12	25
301014P	10	G 1/4	6,5	50	28,4	12	25

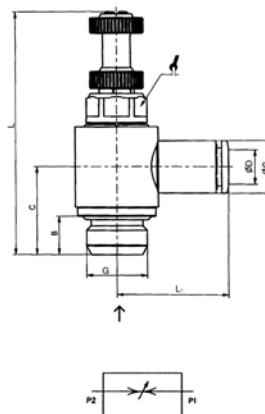

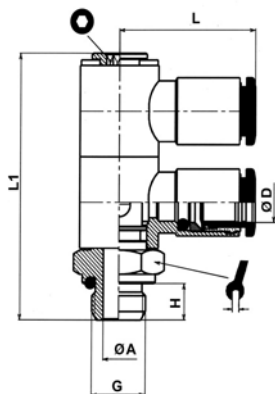

### ART. 33

Doppio anello semplice girevole con asta  
Swivel double banjo stem

CODICE	ØD	G	ØA	H	L <sub>1</sub>	L			
330418	4	1/8	5,5	6	43,8	21,1	14	3	25
330618	6	1/8	5,5	6	43,8	24,3	14	3	25
330818	8	1/8	5,5	6	43,8	24,8	14	3	25
330614	6	1/4	7,8	8	51,5	25,5	18	4	25
330814	8	1/4	7,8	8	51,5	26,5	18	4	25
331014	10	1/4	7,8	8	51,5	28,4	18	4	25

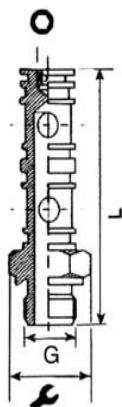

### ART. 33A

Asta doppia per anello girevole  
Double stem for swivel banjo

CODICE	G	L			
33A18	1/8	43,8	14	3	50
33A14	1/4	51,5	18	4	50

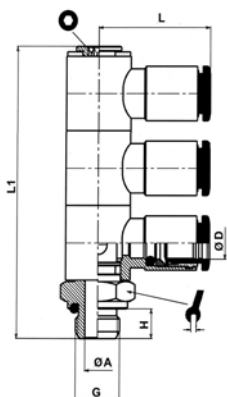

### ART. 34

Triplo anello semplice girevole con asta  
Swivel triple banjo stem

CODICE	ØD	G	ØA	H	L <sub>1</sub>	L			
340418	4	1/8	5,5	6	59	21,1	14	3	10
340618	6	1/8	5,5	6	59	24,3	14	3	10
340818	8	1/8	5,5	6	59	24,8	14	3	10
340614	6	1/4	7,8	8	67	25,5	18	4	10
340814	8	1/4	7,8	8	67	26,5	18	4	10
341014	10	1/4	7,8	8	67	51,5	18	4	10

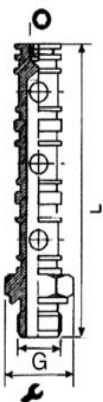

### ART. 34A

Asta tripla per anello girevole  
Triple stem for swivel banjo

CODICE	G	L			
34A18	1/8	59	14	3	50
34A14	1/4	67	18	4	25